

· 本手册所包含内容, 本公司拥有最终解释权, 更多详细资料敬请垂询  
· 本公司工程技术人员将竭诚为您服务, 图片与实物若有出入, 请以实物为准  
· 未经许可, 禁止全部或部分复制  
· 如有变更, 届时恕不另行通知, 衷心希望本手册能给您带来方便  
· 产品不断研发、技术持续创新……

· The company reserves the right to the interpretation of all content in the manual, Please feel free to contact us for more details  
· Our technical staff shall provide best service to you sincerely, If the pictures is different from the real objects, Please refer to real object  
· Unauthorized Use, Prohibited to copy all or part of the information  
· There's no prior notice if any change, Sincerely hope that this manual can bring convenience to you  
· Products research and development, Continuous innovation of technology……

© 浙江强力电力金具有限公司版权所有      珍惜资源, 善待环境  
(c) ZHEJIANG QLG ELECTRIC POWER FITTING CO.,LTD. All rights reserved. Cherish resources, be kind to the environment

# QLG 强力

## 接线端子产品选型

### SELECTION OF TERMINAL PRODUCTS

[www.qlgelc.com](http://www.qlgelc.com)

# QLG 强力

**浙江强力电力金具有限公司**  
ZHEJIANG QLG ELECTRIC POWER FITTING CO.,LTD.

地址: 浙江省乐清经济开发区纬 19 路 257 号

网址: [www.qlgelc.com](http://www.qlgelc.com)    邮箱: [qlg@qlg.net.cn](mailto:qlg@qlg.net.cn)



扫一扫浏览公司网站

真强 真实力

“自强不息，努力超越”这是我们一贯坚持的企业精神；“连接光明，引领未来”这是我们永远追求的企业目标。

我们的优秀根源于强大的设备根基，我们不断的打造自身的实力，让我们的服务增值，让企业核心竞争力蒸蒸日上。

**QLG 强力**

自强不息 努力超越  
Beyond self-improvement efforts

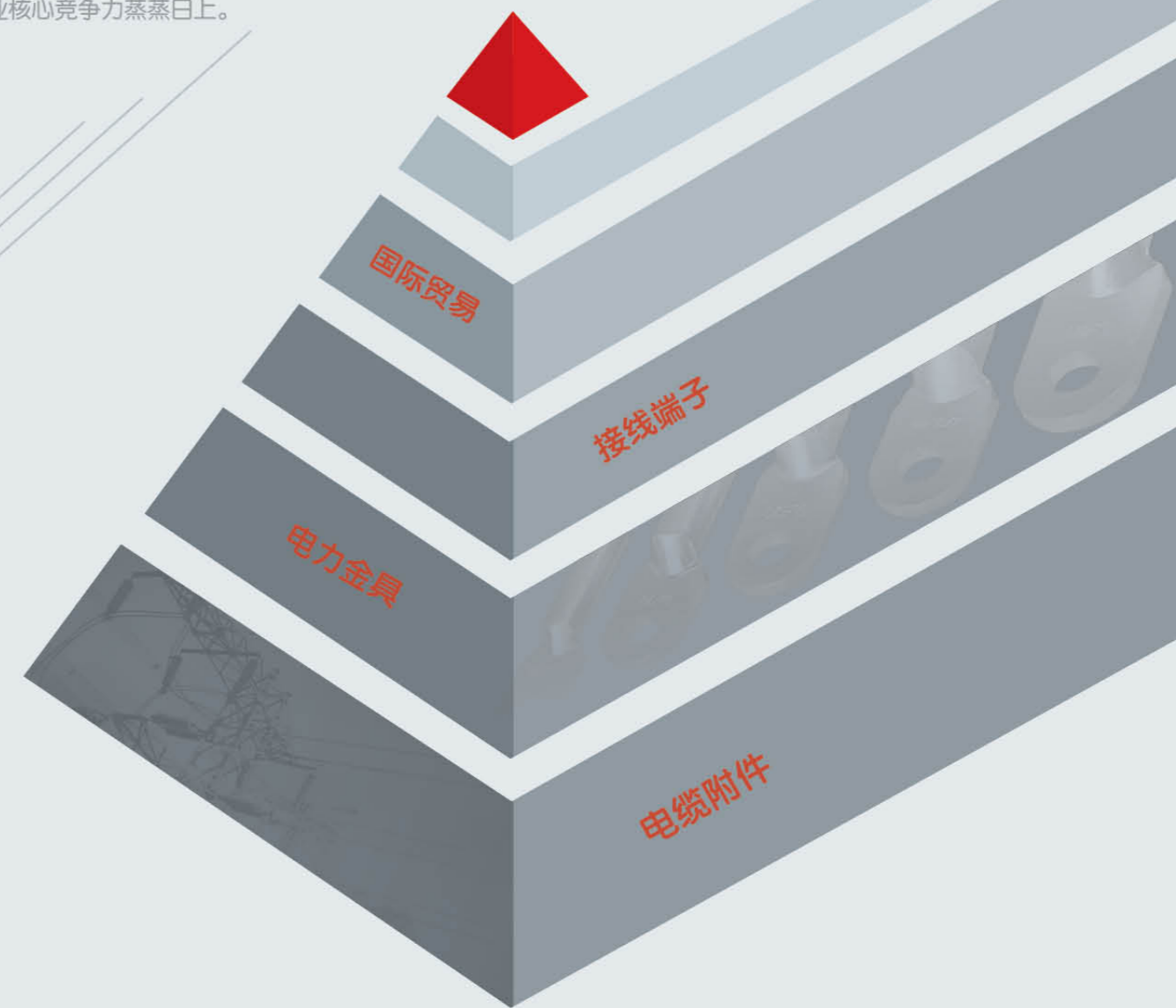

## 企业简介 ENTERPRISE BRIEF INTRODUCTION

**QLG 强力**



Zhejiang Qiangli Electric Power fittings Co., LTD. Is located in Yueqing City, which is the "electrical capital of China". The factory is located in Yueqing Economic development zone.

Founded in 2009, the company specializes in the research, development, production and sales of power fittings, cable accessories and nylon straps. After more than ten years of development, it has become a comprehensive and well-known enterprise specializing in electric power fittings and cable accessories, among which copper and aluminum terminals are the main products of our company and the leading brand in the electric power fittings industry.

The company has 500 employees, a factory area of more than 30,000 square meters, with more than 500 sets of professional equipment. The company has strong technical force, advanced production technology and complete varieties. Existing sales outlets more than 300, sales business throughout the country and abroad.

The company to "unremitting self-improvement, strive to surpass" as the spirit of enterprise; With the goal of "pursuing excellence, leading the industry", we have successively obtained various honors and certificates: "National High-tech Enterprise"; "Small and Medium-sized Technology-based Enterprises in Zhejiang Province"; "Zhejiang Provincial Science and Technology Achievement Award"; Yueqing Enterprise Technology Center.

The company "innovation and development, quality and survival" as the enterprise principle; "Customer first, quality first"

For the purpose of the enterprise, the company constantly improves and improves the product standard construction, patent construction, production level and quality control level of the company: the company is mainly responsible for drafting the "Zhejiang Made" standard of "Copper and aluminum wiring terminals and connecting pipes for Power Cable conductors", and it is the first company to pass the certification of the "product" logo. It has passed ISO9001 quality management system certification, ISO14001 environmental management system certification and OHSAS18001 Occupational Health and safety management system certification.

The company has obtained 2 national product invention patents and 36 utility model patents.

浙江强力电力金具有限公司位于“中国电气之都”乐清柳市，工厂地址位于乐清经济开发区。

公司创建于2009年，专业致力于电力金具、电缆附件和尼龙扎带的研发、生产和销售。经过十多年的发展，已经成为一家专业电力金具和电缆附件的综合性知名企业，其中铜铝类端子是我司的主打产品，是电力金具行业的领军品牌。

公司现有员工500人，工厂面积3万多平方米，拥有各种专业设备500多台套。公司技术力量雄厚，生产工艺先进，品种齐全。现有销售网点300多家，销售业务遍及国内外。

公司以“自强不息、努力超越”为企业精神；以“追求卓越，引领行业”为目标，先后取得各种荣誉和证书：“国家高新技术企业”；“浙江省科技型中小企业”；“浙江省级科学技术成果奖”；“乐清市企业技术中心”。

公司“以创新求发展 以质量求生存”为企业原则；以“用户至上 质量第一”为企业宗旨，不断完善和提升公司的产品标准建设、专利建设、生产水平和质控水平：公司主要负责起草了“浙江制造”《电力电缆导体用压接型铜、铝接线端子和连接管》标准，并首家通过了“品”字标的认证。全面通过了ISO9001质量管理体系认证、ISO14001环境管理体系认证、OHSAS18001职业健康安全管理体系认证。

公司获得了国家产品发明专利2项、实用新型专利36项。

为保证产品质量，公司持续加大生产设施投资力度，不断提升自动化水平；同时采购了先进的ICP发射光谱仪、拉力试验机、镀锡测厚仪和热循环试验机等设备。

公司以“诚信为本 共同发展”为企业方针。以人为本，把企业办成学习型组织；与员工分享公司发展成果；鼓励和尊重每位员工的积极性和创造性。

“长风破浪会有时 直挂云帆济沧海”，浙江强力电力金具有限公司经过十多年的沉淀和发展，已经成为金具行业中具有较大影响力的企业。展望未来，我们将积极推行“聚焦一米宽 深挖百米深”的专业精神，精耕细作，全力创新，真正从“中国制造”走向“中国创造”。

自强不息 努力超越

Beyond self-improvement efforts



In order to ensure the quality of products, the company continues to increase investment in production facilities, and constantly improve the level of automation; At the same time, the advanced ICP emission spectrometer, tensile testing machine, tin thickness meter and thermal cycle testing machine are purchased.

The company takes "good faith as the foundation common development" as the enterprise policy. People-oriented, the enterprise into a learning organization; Share the company's development achievements with employees; Encourage and respect the initiative and creativity of every employee.

"The wind will sometimes break through the waves directly linked to the cloud sail to help the sea", Zhejiang Qiangchuang Electric power gold fittings Co., LTD. After more than ten years of precipitation and development, has become a more influential enterprise in the industry of gold fittings. Looking forward to the future, we will actively promote the professional spirit of "focusing on the width of one meter and the depth of one hundred meters", intensive cultivation, all-out innovation, truly from "made in China" to "created in China".

# 研发中心 RESEARCH AND DEVELOPMENT CENTER

大数据时代，各项研究成果源于翔实的实验数据分析。这是我们业内一流水平的实验室，大数据在这里汇集，如同一片蕴藏量丰富的蓝海，我们在这里细细探究，让每一项工艺流程，都做到精益求精。我们不断的打造自身的实力，让我们的服务增值，让我们的核心竞争力蒸蒸日上。

In the era of mega-data, all the research based on the sufficient data analysis. Here we are equipped with first-rate laboratory, where we can analyze kinds of data of the products and manufacturing, so as to make every little improvement in the each progress of work.



QLG 强力



ZHEJIANG QLG ELECTRIC POWER FITTING CO.,LTD.



## 检测设备 ENTERPRISE BRIEF INTRODUCTION

创新的开发技术 引领潮头；先进的设备工装 独领风骚；精密的检测仪器 配置完备。这是一座技术的王国，这是一座品质的堡垒。“自强不息，努力超越”这是我们一贯坚持的企业精神，“连接光明，引领未来”这是我们永远追求的企业目标。  
Research & development with creativity, which leading in the prior; advanced devices and facilities, which makes distinguish ; sophisticated testing equipment, are here prepared faultlessly. Hence, here is a kingdom of technology, here is a bastion of quality. “beyond self-improvement efforts” is the spirit that we insist since the beginning and towards the future. “Connecting to the rosiness, leading the future” is the eternal vision we are pursuing.

QLG 强力控股  
研发中心



自强不息 努力超越  
Beyond self-improvement efforts



2020年我们构建了“好企业+好产品”的标准体系，负责起草了电缆接线端子的“浙江制造”标准，并一举通过了“品”字标浙江制造产品认证，从此“世界品质，浙江制造”将从我们这里起航；从此，我们也将以往的速度、规模、数量式的增长模式，转型到依靠质量、品牌、效益的“质量时代”。

In the year of 2020, we structured and formatted the standard system of “good enterprise+good product”, and in charge of drafting the standard of “made in Zhejiang” in terms of cable terminal connector, and meanwhile we were authenticated by the logo “品” (quality) of “made in Zhejiang”, since then, we would make another journey towards “world quality, made in Zhejiang”. further, we will upgrade the increment model rely in the speed, scale, and amount to the quality orientation with the basement of quality, brand, and effectiveness.

## 生产设备 PRODUCTION EQUIPMENT

大工必精，我们的优秀根源于强大的设备根基。在这里，设备为我们的制造助力，时光对所有的付出，都会赠与丰厚的回馈，我们渐渐拥有了跻身一流技术的实力。高起点、高投入、高品质，我们秉承这一技术战略，征战商场，纵横驰骋。高技术，高科技，高效率，我们采用世界一流的产品生产线及实验、检测设备。

Great work out from sophistication, our performance rely on the powerful devices and facilities. Here, the equipment contribute its power to the manufacture, time would feedback to all the payment in the end, we therefore gradually gains the strengths as a world class manufacturer. High start point, high investment, high quality, We conquered the business world in according with the strategy. High-tech and high efficiency. We applied the advanced production line and experimental, testing equipment.





## 销售服务 SALES AND SERVICE

我们是一支训练有素，技术精湛的团队，完美的诠释了团结协作的重要性。500 余名员工，每一位员工都像是筑梦的天使，用点点滴滴的日常操作，完美筑就产品质量的良好口碑。300 多家销售网点，星罗棋布在世界地图上。不断拓宽销售的领土，将持续不断地向未知的领域扩张。

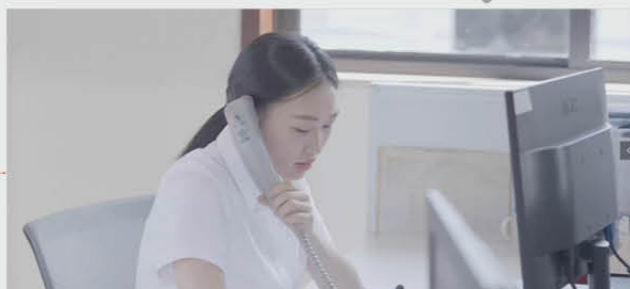

We are a well-trained and skilled team, the work of us do explained the significance of teamwork. Over 500 employees, each employee is an angel to build the dream with their daily work, leading to the quality of product and the value of the brand. As if the star in the sky, chess pieces in the board, we have more than 300 sales outlets over the world. The increasingly broaden sales territory is leading us to the future area of unknown.



——高起点 高投入 高品质——  
High start point, high investment, high quality



**A**

**铜接线端子系列**

DTO 欧式铜接线端子.....	01
DTLO 欧式铜铝接线端子.....	02
DT-A 铜接线端子 (A 型).....	03
DT-B 铜接线端子 (B 型).....	04
DT-S 双孔铜接线端子 (A 型).....	05
DTM 双孔铜接线端子 (国标).....	06
DTM 铜接线端子 (国标).....	07
OT-A 开口铜接线端子 (A 型).....	08
OT-A1 开口铜接线端子 (B 型).....	09
SC 窥口铜接线端子.....	10
DT-G 管压铜接线端子 (A 型).....	11
DT 管压铜接线端子 (国标).....	12
JG 管压铜接线端子.....	13
DTK 空开小头鼻型铜接线端子.....	14
DT-K 空开小头板型铜接线端子.....	15
C45 铜插针.....	16

**B**

**铝接线端子系列**

DL-B 铝接线端子 (B 型).....	17
DLM 铝接线端子 (国标).....	18
DLM 双孔铝接线端子 (国标).....	19

**C**

**铜铝接线端子系列**

C45-G 扁头铜铝插针.....	20
DLT 铝铜接线端子.....	21
DTL-2 出口型铜铝接线端子 (A 型).....	22
DTL-A 铜铝接线端子 (A 型).....	23
DTL-B 铜铝接线端子 (B 型).....	24
DTLK 空开小头鼻型铜铝接线端子.....	25
DTL-K 空开小头板型铜铝接线端子.....	26
DTLQ 铜铝接线端子 (钎焊).....	27
DTL-S 双孔铜铝接线端子 (A 型).....	28
DTL 双孔铜铝接线端子 (国标).....	29
DTL 铜铝接线端子 (国标).....	30

**D**

**接线管系列**

GLG-A 通孔铝连接管 (A 型).....	31
GLG-B 通孔铝连接管 (B 型).....	32
GLM 堵油式铝连接管 (国标).....	33
GTG-A 通孔铜连接管 (A 型).....	34
GTG-B 通孔铜连接管 (B 型).....	35
GTL 铜铝连接管.....	36
GTM 堵油式铜连接管 (国标).....	37

**Copper terminal series  
铜接线端子系列**

◎ DTO 欧式铜接线端子



型号规格	Ø	D	d	L <sub>1</sub>	L <sub>2</sub>	W	S	L
DTO-25	17	11	7	50	40	30	10	100
DTO-35	17	12	8.5	50	40	30	10	100
DTO-50	17	14	9.7	50	40	30	10	100
DTO-70	17	16	12.1	50	40	30	10	100
DTO-95	17	18	13.2	50	40	30	10	100
DTO-120	17	20	15.1	50	40	30	10	100
DTO-150	17	22	16.2	50	40	30	10	100
DTO-185	17	25	18.2	50	40	30	10	100
DTO-240	17	27	20.2	50	40	30	10	100
DTO-300	17	30	23.2	50	40	30	10	100
DTO-400	17	34	26.2	50	40	30	10	100
DTO-500	17	38	29.2	50	40	30	10	100

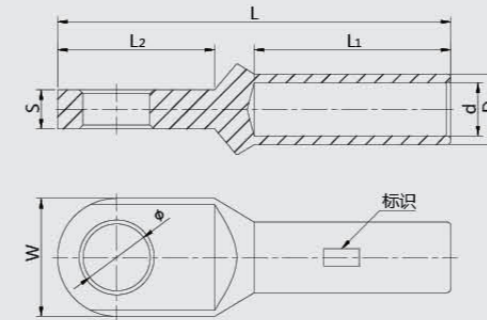

## Copper and Aluminum Terminal Series 铜铝接线端子系列

### ◎ DTLO 欧式铜铝接线端子

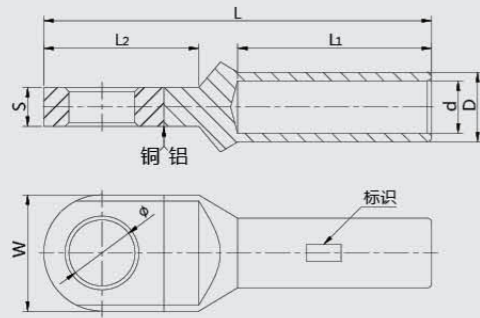

型号规格	Ø	D	d	L <sub>1</sub>	L <sub>2</sub>	W	S	L
DTLO-25	17	12	7	50	40	30	10	100
DTLO-35	17	14	8.5	50	40	30	10	100
DTLO-50	17	16	9.7	50	40	30	10	100
DTLO-70	17	18	12.1	50	40	30	10	100
DTLO-95	17	21	13.2	50	40	30	10	100
DTLO-120	17	23	15.1	50	40	30	10	100
DTLO-150	17	25	16.2	50	40	30	10	100
DTLO-185	17	27	18.2	50	40	30	10	100
DTLO-240	17	30	20.2	50	40	30	10	100
DTLO-300	17	34	23.2	50	40	30	10	100
DTLO-400	17	38	26.2	50	40	30	10	100
DTLO-500	17	40	29.2	50	40	30	10	100

## Copper terminal series 铜接线端子系列

### ◎ DT-A 铜接线端子 (A型)

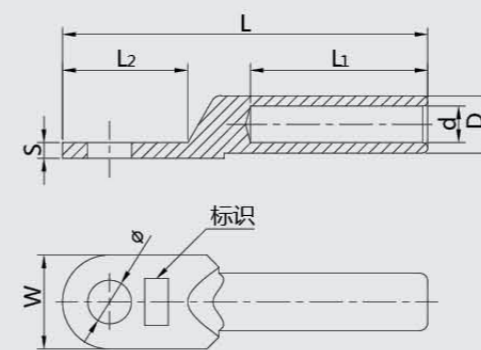

型号规格	Ø	D	d	L <sub>1</sub>	L <sub>2</sub>	W	S	L
DT-A-10	8.5	9	5.3	30	22	16	2.3	63
DT-A-16	8.5	10	6.3	32	22.5	16	2.5	66
DT-A-25	8.5	11	7.3	35	25	18	2.8	70
DT-A-35	10.5	12	8.5	37	29	20	3	78
DT-A-50	10.5	14	9.5	41	31	23	3.5	85
DT-A-70	12.5	16	11.5	45	33.5	26	3.8	93
DT-A-95	12.5	18	13.5	49	37	28	4.5	104
DT-A-120	14.5	20	15.1	51	41	30	5	112
DT-A-150	14.5	22	16.5	54	43	34	5.4	117
DT-A-185	16.5	25	18.5	58	44	38	5.8	125
DT-A-240	17	27	20.7	60	50	40	6.5	135
DT-A-300	21	30	23.5	68	58	46	8	155
DT-A-400	21	34	26.2	73	61	50	8.5	165
DT-A-500	21	38	29.2	75	69	60	9.5	190
DT-A-630	方头	45	34.3	85	85	78	10	220



Copper terminal series  
铜接线端子系列

◎ DT-B 铜接线端子 ( B 型 )

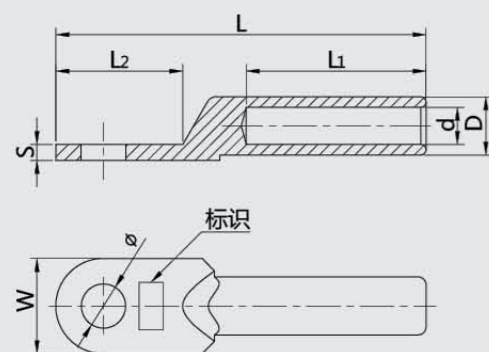

型号规格	Ø	D	d	L <sub>1</sub>	L <sub>2</sub>	W	S	L
DT-B-10	8.5	8	5.3	28	21	14.5	1.8	58
DT-B-16	8.5	9	6.3	30	22	14.5	2	60
DT-B-25	8.5	10	7.3	30	24	16	2.4	65
DT-B-35	10.5	11	8.2	32	27	18	2.6	70
DT-B-50	10.5	13	9.5	35	27	20	3	75
DT-B-70	12.5	15	11.5	40	30	23	3.1	85
DT-B-95	12.5	17	13.5	41	33	26	3.4	91
DT-B-120	14.5	19	15.1	44	33	28	3.7	96
DT-B-150	14.5	21	16.5	46	35	30	4	100
DT-B-185	17	24	18.5	49	37	33	4.2	107
DT-B-240	17	26	20.7	53	41	35	4.5	116
DT-B-300	21	29	23.5	61	50	42	5.5	138
DT-B-400	21	34	26.2	73	59	50	7.5	160
DT-B-500	21	38	29.2	73	67	55	8	175
DT-B-630	21	45	34.3	80	78	60	10	205

Copper terminal series  
铜接线端子系列

◎ DT-S 双孔铜接线端子 ( A 型 )

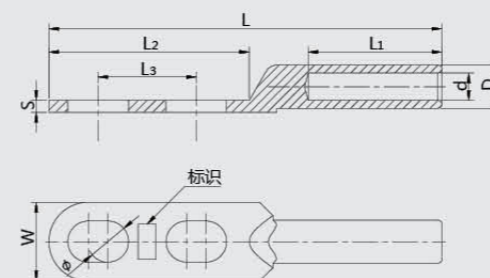

型号规格	Ø	D	d	L <sub>1</sub>	L <sub>2</sub>	L <sub>3</sub>	W	S	L
DT-25S	10.5	11	7.3	34	51	20~30	20	2.5	100
DT-35S	10.5	12	8.5	37	53	20~30	20	2.6	102
DT-50S	10.5	14	9.5	40	54	20~30	23	3	107
DT-70S	12.5	16	11.5	43	58	20~30	26	3.5	118
DT-95S	12.5	18	13.5	48	60	20~30	28	3.8	126
DT-120S	13	20	15.1	51	67	25~35	30	4.2	138
DT-150S	13	22	16.5	54	68	25~35	34	4.8	142
DT-185S	13	25	18.5	58	76	30~40	37	5.5	157
DT-240S	13	27	20.7	60	78	30~40	40	6	163
DT-300S	16.5	30	23.5	64	83	34~41	46	7	175
DT-400S	16.5	34	26.2	70	85	34~41	50	7.5	185

Copper terminal series  
铜接线端子系列

◎ DTM 双孔铜接线端子 ( 国标 )



型号规格	∅	D	d	L <sub>1</sub>	L <sub>2</sub>	L <sub>3</sub>	W	S	L
DTM-25	10.5	11	7	34	51	25	20	3	100
DTM-35	10.5	12	8.5	36	53	25	20	3	102
DTM-50	10.5	14	9.6	40	54	25	23	3.5	107
DTM-70	12.5	16	12	44	58	25	26	4	118
DTM-95	12.5	18	13	47	60	25	28	4.5	126
DTM-120	13	20	15	50	67	30	30	5	138
DTM-150	13	22	16	54	68	30	34	5.5	142
DTM-185	13	25	18	56	76	35	38	6	157
DTM-240	13	27	20	60	78	35	42	7	163
DTM-300	16.5	30	23	65	83	37.5	48	8	175
DTM-400	16.5	34	26	70	85	37.5	54	9	185

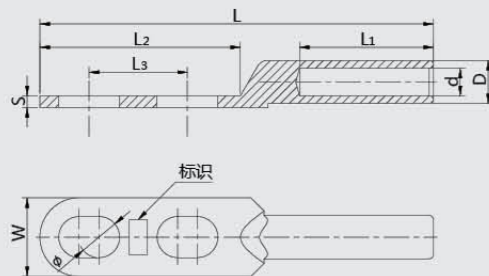

Copper terminal series  
铜接线端子系列

◎ DTM 铜接线端子 ( 国标 )



型号规格	∅	D	d	L <sub>1</sub>	L <sub>2</sub>	W	S	L
DTM-10	8.4	9	5.5	30	19	16	2.2	66
DTM-16	8.4	10	6	31	21	16	2.5	67
DTM-25	8.4	11	7	34	24	18	3	70
DTM-35	10.5	12	8.5	36	27	20	3	79
DTM-50	10.5	14	9.6	40	29	23	3.5	87
DTM-70	12.5	16	12	44	31	26	4	95
DTM-95	12.5	18	13	47	35	28	4.5	105
DTM-120	14.5	20	15	50	38	30	5	112
DTM-150	14.5	22	16	54	40	34	5.5	118
DTM-185	16.5	25	18	56	42	38	6	125
DTM-240	16.5	27	20	60	48	42	7	136
DTM-300	21	30	23	65	57	48	8	160
DTM-400	21	34	26	70	58	54	9	165
DTM-500	21	38	29	75	68	64	9.5	190
DTM-630	方头	45	34	85	85	78	10	220
DTM-800	方头	50	38	85	105	100	10.5	260

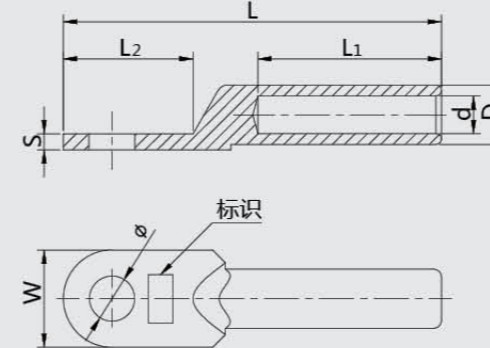

Copper terminal series  
铜接线端子系列

◎ OT-A 开口铜接线端子 (A 型)



型号规格	适用导线 mm <sup>2</sup>	Φ	H	R	r	C	A	L
OT-10A	1.5~4	5.2	7	4.5	2.5	6	0.9	19
OT-20A	1.5~6	6.2	7.5	5.5	3	7	1	22.5
OT-30A	2.5~6	6.2	8	5.5	3.2	8	1.1	23.5
OT-40A	4~10	6.2	9	6	3.5	8	1.1	26
OT-50A	4~10	6.2	9.5	6.5	3.7	8.5	1.2	28.5
OT-60A	4~16	8.2	10	7	4	9	1.3	31
OT-80A	6~16	8.2	10.5	7.5	4.5	10.3	1.4	33
OT-100A	10~25	8.2	11	8.5	5	11	1.5	35.5
OT-150A	16~35	10.2	12	9	5.5	12.5	1.6	40
OT-200A	16~35	10.2	13	9.5	6	13	2	42.5
OT-250A	16~50	10.2	15	10.5	7	16	2.2	45.5
OT-300A	25~70	12.2	16	11	7.5	17	2.4	47
OT-400A	35~95	14.2	18	12	8	18	2.6	53
OT-500A	50~120 <sup>2</sup>	14.2	20	13.5	9	20	2.7	61.5
OT-600A	70~150 <sup>2</sup>	16.2	22.5	15	11	23	2.8	65
OT-800A	90~180 <sup>2</sup>	18.2	27	17	12.5	27	3.2	73
OT-1000A	100~200 <sup>2</sup>	18.2	33	20	16	35	3.6	84

Copper terminal series  
铜接线端子系列

◎ OT-A<sub>1</sub> 开口铜接线端子 (B 型)



型号规格	适用导线 mm <sup>2</sup>	Φ	H	R	r	C	A	L
OT-10A <sub>1</sub>	1.5~4	5.2	7	4.5	2.5	6	0.6	19
OT-20A <sub>1</sub>	1.5~6	6.5	7.5	5.5	3	7	0.7	22.5
OT-30A <sub>1</sub>	2.5~6	6.5	8	5.5	3	8	0.7	23.5
OT-40A <sub>1</sub>	4~10	6.5	8.5	6	3.5	8	0.8	25
OT-50A <sub>1</sub>	4~10	6.5	9	6.5	4	8.5	0.9	28
OT-60A <sub>1</sub>	4~16	8.5	9	7	4	9	1	29
OT-80A <sub>1</sub>	6~16	8.5	10	7.5	4.5	10.3	1	32.5
OT-100A <sub>1</sub>	10~25	8.5	10.5	8.5	5	11	1.1	35
OT-150A <sub>1</sub>	16~35	10.5	11	9	5.5	12.5	1.2	39
OT-200A <sub>1</sub>	16~35	10.5	12	9.5	6	13	1.4	41.5
OT-250A <sub>1</sub>	16~50	10.5	14	10.5	7	16	1.6	44.5
OT-300A <sub>1</sub>	25~70	12.5	15	11	7.5	17	1.7	46
OT-400A <sub>1</sub>	35~95	14.5	17	12	8	18	1.9	52
OT-500A <sub>1</sub>	50~120	14.5	18.5	13.5	9	20	2	61.5
OT-600A <sub>1</sub>	70~150	16.5	20.5	15	11	23	2.1	65

Copper terminal series  
铜接线端子系列

◎ SC 窥口铜接线端子

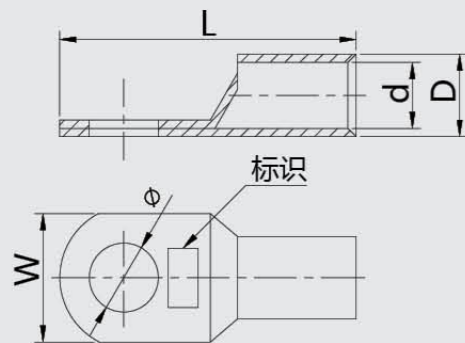

型号规格	Ø	D	d	W 参考值	L
SC-1.5	4.2/5.2/6.2	3.5	2.5	8.5	18
SC-2.5	4.2/5.2/6.2	4	3	8.5	19
SC-4	4.2/5.2/6.2	5	4	8.8	20
SC-6	6.2/8.2	6	4.8	9	24
SC-10	6.2/8.2	6.5	5.3	10	27
SC-16	6.2/8.2/10.5	8	6.2	12	31
SC-25	6.2/8.2/10.5	9	7	13.5	33
SC-35	8.2/10.5/12.5	10.5	8.5	15.5	38
SC-50	8.2/10.5/12.5	12.5	10.1	18.5	45
SC-70	8.2/10.5/12.5	14.5	12	21.5	50
SC-95	10.5/12.5	17	14	25.5	56
SC-120	10.5/12.5/14.5	19	15.5	28	61
SC-150	12.5/14.5/16.5	21	17	31	68
SC-185	12.5/14.5/16.5	24	19	35	76
SC-240	12.5/14.5/16.5	27	21.6	40	90
SC-300	16.5	30	24	44	100
SC-400	16.5/18.5	32	26	47	110
SC-500	20.5	38	30	56	123
SC-630	20.5	45	36	67	135
SC-800	22.5	50	41	75	170
SC-1000	22.5	55	46	82	200

Copper terminal series  
铜接线端子系列

◎ DT-G 管压铜接线端子 (A型)

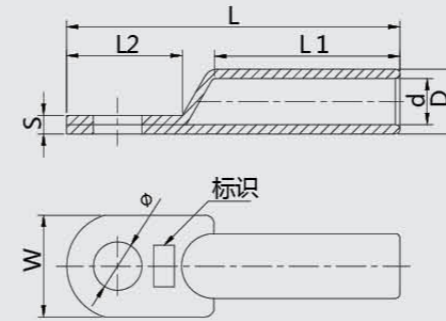

型号规格	Ø	D	d	L <sub>1</sub>	L <sub>2</sub>	W 参考值	S	L
DT-G-10	8.2	8	5.4	30	18	12	2.6	51
DT-G-16	8.2	9	6.2	31	19	13.5	2.8	56
DT-G-25	8.2	10	7.2	34	20	14.5	2.8	61
DT-G-35	10.5	11	8.2	36	23	16.5	2.8	66
DT-G-50	10.5	13	10	40	25	18	3	72
DT-G-70	12.5	16	12	42	27	23.5	4	80
DT-G-95	12.5	18	14	46	31	26.5	4	86
DT-G-120	14.5	20	15.6	48	35	28.5	4.4	95
DT-G-150	14.5	22	17.4	52	37	32.5	4.6	103
DT-G-185	16.5	25	19.2	55	42	36.5	5.8	114
DT-G-240	16.5	27	21	60	43	40	6	120
DT-G-300	18.5	30	24	65	45	44	6	135
DT-G-400	18.5	33	26	70	51	48	7	156
DT-G-500	20.5	40	32	75	59	60	8	170
DT-G-630	20.5	45	35	85	68	67	10	210
DT-G-800	22.5	50	40	85	80	75	10	270
DT-G-1000	24.5	56	45	90	90	83	11	290

Copper terminal series  
铜接线端子系列

◎ DT 管压铜接线端子 ( 国标 )

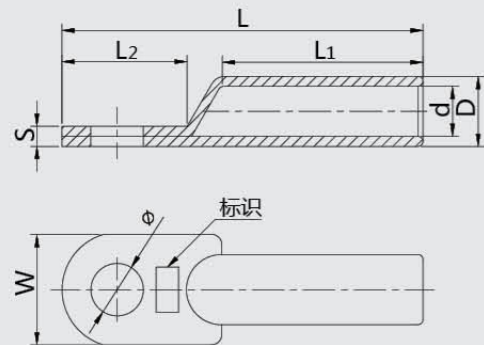

型号规格	Ø	D	d	L <sub>1</sub>	L <sub>2</sub>	W 参考值	L
DT-10	6.5	8	5	30	18	10	50
DT-16	6.5	9	6	31	19	12	55
DT-25	6.5	10	7	34	20	14	60
DT-35	8.4	12	8.5	36	23	16	66
DT-50	8.4	14	10	40	25	19	72
DT-70	10.5	16	12	42	27	22	80
DT-95	10.5	18	13	46	31	25	87
DT-120	13	20	15	48	35	28	96
DT-150	13	22	16	52	37	32	103
DT-185	16.5	25	18	55	42	36	115
DT-240	16.5	27	20	60	43	40	120
DT-300	17	31	24	65	45	45	135
DT-400	17	34	26	70	51	50	150
DT-500	/	38	30	75	59	56	170
DT-630	/	45	35	85	68	65	210

Copper terminal series  
铜接线端子系列

◎ JG 管压铜接线端子

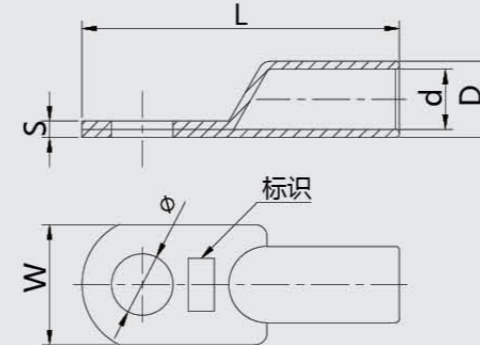

型号规格	Ø	D	d	W 参考值	S	L
JG-10	6.2/8.2	8	6	12	2	38
JG-16	6.2/8.2	9	7	13.5	2	41
JG-25	8.2/10.5	10	7.8	14.5	2.2	46
JG-35	8.2/10.5	11	8.8	16.5	2.2	52
JG-50	8.2/10.5/12.5	13	10.6	18	2.4	54
JG-70	8.2/10.5/12.5	16	12.8	23.5	3.2	61
JG-95	10.5/12.5	18	14.8	26.5	3.2	66
JG-120	10.5/12.5	20	16	28.5	4	73
JG-150	12.5/14.5/16.5	22	18	32.5	4	77
JG-185	14.5/16.5	25	20	36.5	5	86
JG-240	16.5	27	21	40	6	92
JG-300	16.5	30	24	44	6	103
JG-400	20.5	33	26	48	7	113
JG-500	20.5	40	32	60	8	142
JG-630	22.5	45	36	67	9	155
JG-800	22.5	50	40	75	10	170

Copper terminal series  
铜接线端子系列

◎ DTK 空开小头鼻型铜接线端子

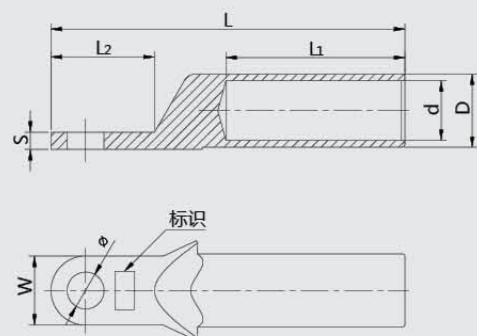

型号规格	Ø	D	d	L <sub>1</sub>	L <sub>2</sub>	W	S	L
DTK-35	8.5	11	8.2	31	24	16	4	66
DTK-50	8.5	13	9.5	36	24	16	4	72
DTK-70	8.5	15	11.5	40	24	16	4	79
DTK-95	8.5	17	13.5	41.5	24	16	4	82
DTK-120	8.5	19	15.1	44	24	16	4.5	87
DTK-150	8.5	21	16.5	46	24	16	5.5	89
DTK-185	8.5	24	18.5	50	24	16	6	94
DTK-240	8.5	26	20.7	53	24	16	7	99

Copper terminal series  
铜接线端子系列

◎ DT-K 空开小头板型铜接线端子

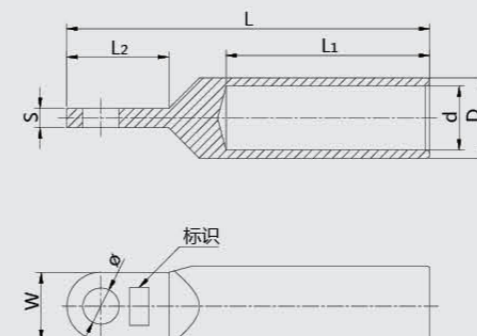

型号规格	Ø	D	d	L <sub>1</sub>	L <sub>2</sub>	W	S	L
DT-35K	8.5	11	8.5	32	23	16	4	67
DT-50K	8.5	13	9.5	35	24	16	4	70
DT-70K	8.5	15	11.5	40	24	16	4	75
DT-95K	8.5	17	13.5	45	24	16	4	82.5
DT-120K	8.5	19	15.1	48	24	16	4.5	85.5

Copper terminal series  
铜接线端子系列

◎ C45 铜插针

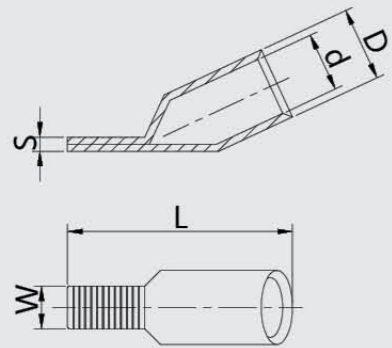

型号规格	D	d	W	S	L
C45-6	6	4.7	4.6	1.3	26
C45-10	6.5	5.2	5.8	1.3	31
C45-16	8	6.2	7.2	1.8	34
C45-25	9	7	7.2	2	36
C45-35	10.5	8.5	7.2	2	38
C45-50	12.5	10.1	7.2	2.4	42
C45-70	14.5	12	7.2	2.5	47
C45-95	17	14	7.2	3	56

Aluminium terminal series  
铝接线端子系列

◎ DL-B 铝接线端子 (B型)

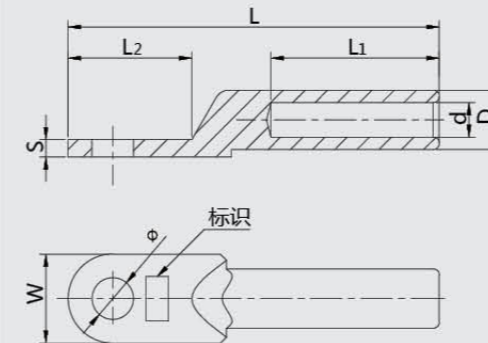

型号规格	Ø	D	d	L <sub>1</sub>	L <sub>2</sub>	W	S	L
DL-B-16	8.4	10	6.3	32	22.5	16	2.5	66
DL-B-25	8.4	11	7.3	35	25	18	2.8	70
DL-B-35	10.5	12	8.5	37	29	20	3	78
DL-B-50	10.5	14	9.5	41	31	23	3.5	85
DL-B-70	12.5	16	11.5	45	33.5	26	3.8	93
DL-B-95	12.5	18	13.5	49	37	28	4.5	104
DL-B-120	14.5	20	15.1	51	41	30	5	112
DL-B-150	14.5	22	16.5	54	43	34	5.4	117
DL-B-185	16.5	25	18.5	58	44	37	5.8	125
DL-B-240	16.5	27	20.7	60	50	40	6.5	135
DL-B-300	21	30	23.5	68	58	45	8	155
DL-B-400	21	34	26.2	68	59	52	8.5	160

Aluminium terminal series  
铝接线端子系列

◎ DLM 铝接线端子 ( 国标 )

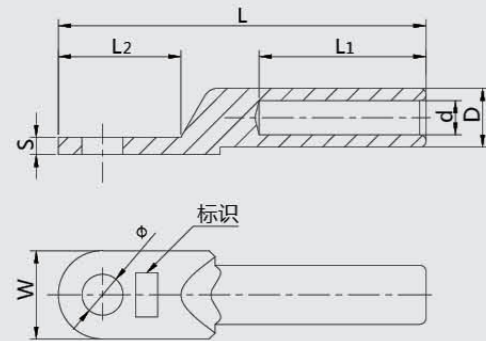

型号规格	Ø	D	d	L <sub>1</sub>	L <sub>2</sub>	W	S	L
DLM-16	8.4	10	5.5	32	22	16	3	70
DLM-25	8.4	12	7	34	25	18	3.5	75
DLM-35	10.5	14	8.5	40	29	20	3.5	85
DLM-50	10.5	16	9.5	42	31	23	4	90
DLM-70	12.5	18	12	47	34	26	4.5	102
DLM-95	12.5	21	13	50	36	28	5	112
DLM-120	14.5	23	15	53	40	30	5.5	120
DLM-150	14.5	25	16	55	42	34	6	126
DLM-185	16.5	27	18	58	47	37	6.5	133
DLM-240	16.5	30	20	60	50	40	7.5	140
DLM-300	21	34	23	65	62	45	8.5	165
DLM-400	21	38	26	70	62	52	9.5	170
DLM-500	21	42	29	75	67	60	10	190
DLM-630	方头	54	34	80	85	78	10.5	225

Aluminium terminal series  
铝接线端子系列

◎ DLM 双孔铝接线端子 ( 国标 )

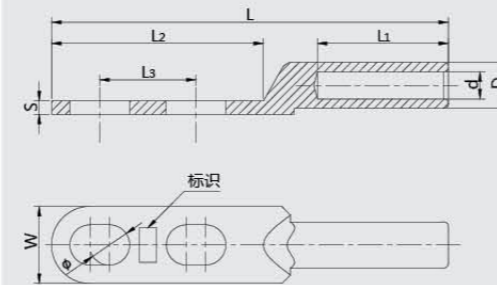

型号规格	Ø	D	d	L <sub>1</sub>	L <sub>2</sub>	L <sub>3</sub>	W	S	L
DLM-25	10.5	12	7	34	54	25	20	3.5	103
DLM-35	10.5	14	8.5	40	54	25	20	3.5	108
DLM-50	10.5	16	9.5	42	57	25	23	4	115
DLM-70	12.5	18	12	47	61	25	26	4.5	125
DLM-95	12.5	21	13	50	65	25	28	5	135
DLM-120	13	23	15	53	71	30	30	5.5	148
DLM-150	13	25	16	55	73	30	34	6	152
DLM-185	13	27	18	58	80	35	37	6.5	166
DLM-240	13	30	20	60	82	35	40	7.5	170
DLM-300	16.5	34	23	65	89	37.5	45	8.5	187
DLM-400	16.5	38	26	70	89	37.5	52	9.5	194



## Copper and Aluminum Terminal Series 铜铝接线端子系列

### ◎ C45-G 扁头铜铝插针



型号规格	D	d	L <sub>1</sub>	L <sub>2</sub>	W	S	L
C45-G-16	10	6.3	20	15.5	7	3.6	45
C45-G-25	11	7	22	15.5	7	5	47
C45-G-35	12	8.2	22	15.5	7	5	47
C45-G-50	14	9.5	24	15.5	7	5	49

## Copper and Aluminum Terminal Series 铜铝接线端子系列

### ◎ DLT 铝铜接线端子



型号规格	∅	D	d	L <sub>1</sub>	L <sub>2</sub>	W	S	L
DLT-16	8.4	10	6.3	31	22.5	16	2.5	66
DLT-25	8.4	11	7.3	34	25	18	2.8	70
DLT-35	10.5	12	8.5	36	29	20	3.0	78
DLT-50	10.5	14	9.5	37	31	23	3.5	85
DLT-70	12.5	16	11.5	43	33.5	26	3.8	95
DLT-95	12.5	18	13.5	46	37	28	4.5	104
DLT-120	14.5	20	15.1	47	41	30	5.0	112
DLT-150	14.5	22	16.5	49	43	34	5.4	117
DLT-185	16.5	25	18.5	52	44	37	5.8	125
DLT-240	16.5	27	20.7	58	50	40	6.5	135
DLT-300	21	30	23.5	63	58	45	8.0	155

## Copper and Aluminum Terminal Series 铜铝接线端子系列

### DTL-2 出口型铜铝接线端子 (A型)

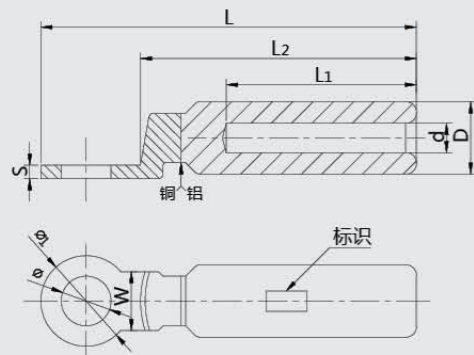

型号规格	Ø	D	d	L <sub>1</sub>	L <sub>2</sub>	Ø <sub>1</sub>	W	S	L
DTL-2-10	11	16	5.5	42	61	20	13	3	83
DTL-2-16	11	16	5.5	42	61	20	13	3	83
DTL-2-25	11	16	6.5	42	61	20	13	3	83
DTL-2-35	11	16	8	42	61	20	13	3	83
DTL-2-50	13	20	9	43	64	26	17	4.5	90
DTL-2-70	13	20	11	43	64	26	17	4.5	90
DTL-2-95	13	20	12.5	43	64	26	17	4.5	90
DTL-2-120	13	25	13.5	60	83	30	21	6	115
DTL-2-150	13	25	15.5	60	83	30	21	6	115
DTL-2-185	13	32	17.5	60	88	35	26	7.5	125
DTL-2-240	13	32	19.5	60	88	35	26	7.5	125
DTL-2-300	13	34	22.5	62	97	36	29	8	135
DTL-2-400	13	38	26	75	112	36	29	8	150
DTL-2-500	17	40	29	90	127	36	29	8	165

## Copper and Aluminum Terminal Series 铜铝接线端子系列

### DTL-A 铜铝接线端子 (A型)

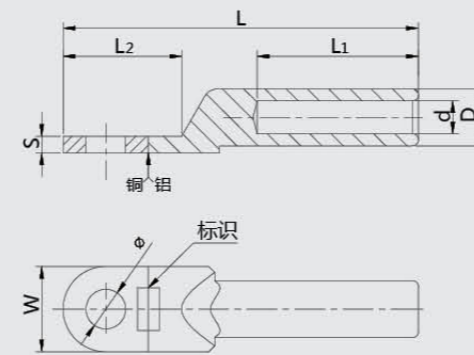
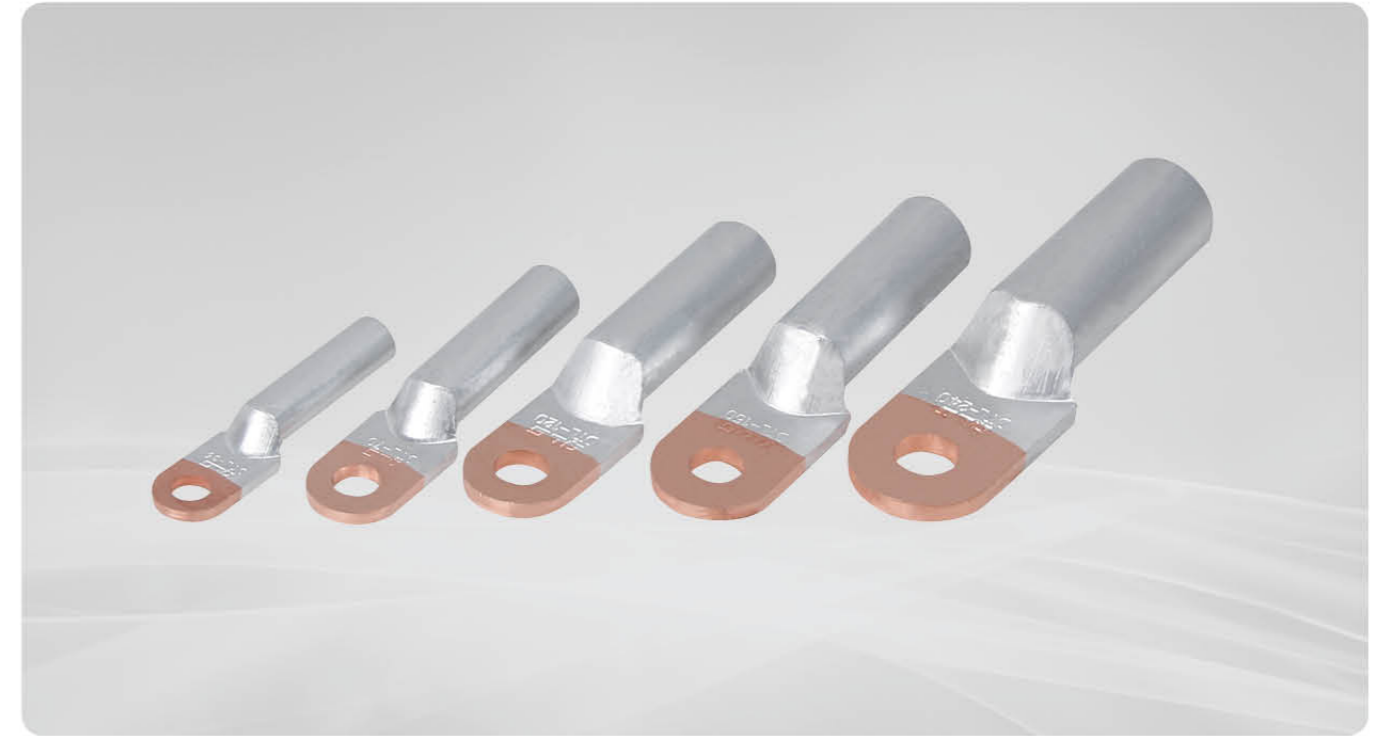

型号规格	Ø	D	d	L <sub>1</sub>	L <sub>2</sub>	W	S	L
DTL-A-10	8.5	10	5.3	30	22	16	2.5	64
DTL-A-16	8.5	11	6.3	33	24	16	3	70
DTL-A-25	8.5	12	7.3	36	25	18	3.2	75
DTL-A-35	10.5	14	8.5	42	30	20	3.5	85
DTL-A-50	10.5	16	9.5	43	31	23	4	90
DTL-A-70	12.5	18	11.5	50	36	26	4.5	102
DTL-A-95	12.5	21	13.5	53	40	28	5	112
DTL-A-120	14.5	23	15.1	55	42	30	5.2	120
DTL-A-150	14.5	25	16.5	57	45	34	5.8	126
DTL-A-185	17	27	18.5	60	46	37	6.5	133
DTL-A-240	17	30	20.7	62	50	40	7	140
DTL-A-300	21	34	23.5	66	59	46	8.5	160
DTL-A-400	21	38	26.2	72	61	50	8.7	168

## Copper and Aluminum Terminal Series 铜铝接线端子系列

### DTL-B 铜铝接线端子 (B型)

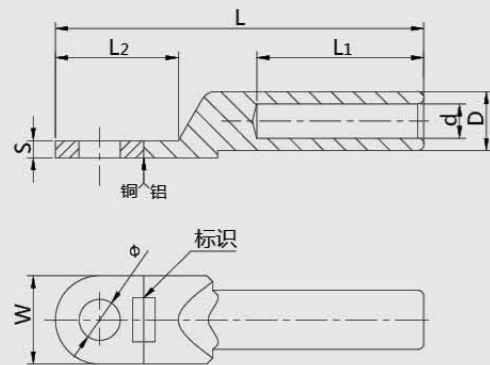

型号规格	Ø	D	d	L <sub>1</sub>	L <sub>2</sub>	W	S	L
DTL-B-10	8.5	10	6.3	28	22	14.5	2	64
DTL-B-16	8.5	10	6.3	28	22	14.5	2	64
DTL-B-25	8.5	11	7.3	28	24	16	2.2	68
DTL-B-35	10.5	12	8.2	31	26	18	2.3	74
DTL-B-50	10.5	14	9.2	38	28	20	2.6	82
DTL-B-70	12.5	16	11.2	41	32	23	3	92
DTL-B-95	12.5	18	13.2	43	34	26	3.2	98
DTL-B-120	14.5	20	15.1	46	35	28	3.6	104
DTL-B-150	14.5	22	16.1	47	41	30	4	113
DTL-B-185	17	24	18.2	52	44	33	4	120
DTL-B-240	17	28	20.2	57	45	35	4.7	130
DTL-B-300	21	32	23.2	61	53	42	5.2	148
DTL-B-400	21	36	26.2	68	60	46	6.5	163
DTL-B-500	21	42	29.2	75	70	55	9	185
DTL-B-630	21	50	34.3	82	82	60	10.5	215

## Copper and Aluminum Terminal Series 铜铝接线端子系列

### DTLK 空开小头鼻型铜铝接线端子

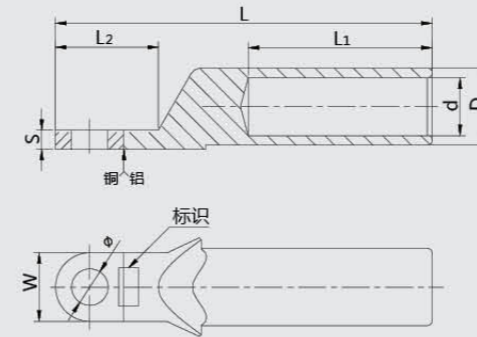

型号规格	Ø	D	d	L <sub>1</sub>	L <sub>2</sub>	W	S	L
DTLK-35	8.5	12	8.2	34	24	16	4	71
DTLK-50	8.5	14	9.2	38	24	16	4	78
DTLK-70	8.5	16	11.2	41	24	16	4	84
DTLK-95	8.5	18	13.2	43	24	16	4	87
DTLK-120	8.5	20	15.1	45	24	16	4.5	92
DTLK-150	8.5	22	16.5	47	24	16	5.5	96
DTLK-185	8.5	24	18.5	50	24	16	6	100
DTLK-240	8.5	28	20.7	57	24	16	7	109

## Copper and Aluminum Terminal Series 铜铝接线端子系列

### DTL-K 空开小头板型铜铝接线端子



型号规格	Ø	D	d	L <sub>1</sub>	L <sub>2</sub>	W	S	L
DTL-35K	8.5	12	8.2	34	23	16	4	70
DTL-50K	8.5	14	9.2	38	24	16	4	77
DTL-70K	8.5	16	11.2	41	24	16	4	80
DTL-95K	8.5	18	13.2	43	24	16	4	83
DTL-120K	8.5	20	15.1	46	24	16	4.5	88

## Copper and Aluminum Terminal Series 铜铝接线端子系列

### DTLQ 铜铝接线端子 (钎焊)



型号规格	Ø	D	d	L <sub>1</sub>	L <sub>2</sub>	W	S	L
DTLQ-16	8.4	10	5.5	32	22	16	3	70
DTLQ-25	8.4	12	7	34	25	18	3.5	75
DTLQ-35	10.5	14	8.5	40	29	20	3.5	85
DTLQ-50	10.5	16	9.5	42	31	23	4	90
DTLQ-70	12.5	18	12	47	34	26	4.5	102
DTLQ-95	12.5	21	13	50	36	28	5	112
DTLQ-120	14.5	23	15	53	40	30	5.5	120
DTLQ-150	14.5	25	16	55	42	34	6	126
DTLQ-185	16.5	27	18	58	47	37	6.5	133
DTLQ-240	16.5	30	20	60	50	40	7.5	140
DTLQ-300	21	34	23	65	62	45	8.5	165
DTLQ-400	21	38	26	70	62	52	9.5	170

## Copper and Aluminum Terminal Series 铜铝接线端子系列

### DTL-S 双孔铜铝接线端子 (A型)

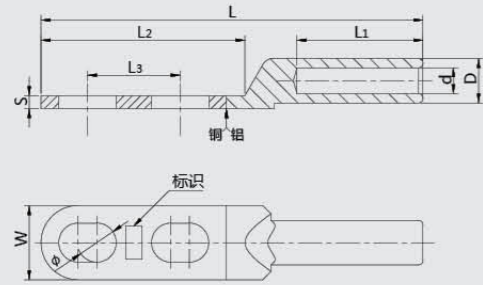

型号规格	Ø	D	d	L <sub>1</sub>	L <sub>2</sub>	L <sub>3</sub>	W	S	L
DTL-25S	10.5	12	7.3	34	55	20~30	20	2.8	103
DTL-35S	10.5	14	8.5	36	55	20~30	20	3.2	107
DTL-50S	10.5	16	9.5	40	57	20~30	23	3.6	115
DTL-70S	12.5	18	11.5	44	63	20~30	26	4	125
DTL-95S	12.5	21	13.5	44	66	20~30	28	4.2	135
DTL-120S	13	23	15.1	52	73	25~35	30	4.6	148
DTL-150S	13	25	16.5	54	74	25~35	34	5.2	152
DTL-185S	13	27	18.5	56	81	30~40	37	5.8	166
DTL-240S	13	30	20.7	57	83	30~40	40	6.4	168
DTL-300S	16.5	34	23.5	61	90	34~41	46	7.5	185
DTL-400S	16.5	38	26.2	69	90	34~41	50	8	194

## Copper and Aluminum Terminal Series 铜铝接线端子系列

### DTL 双孔铜铝接线端子 (国标)

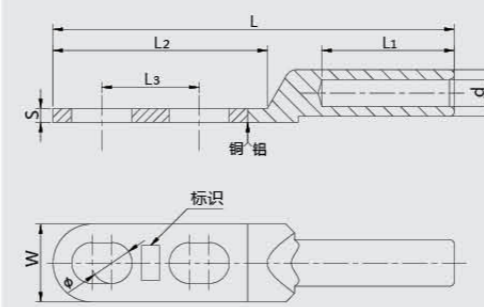

型号规格	Ø	D	d	L <sub>1</sub>	L <sub>2</sub>	L <sub>3</sub>	W	S	L
DTL-25	10.5	12	7	34	55	25	20	3.5	103
DTL-35	10.5	14	8.5	40	55	25	20	3.5	108
DTL-50	10.5	16	9.5	42	57	25	23	4	115
DTL-70	12.5	18	12	47	62	25	26	4.5	125
DTL-95	12.5	21	13	50	66	25	28	5	135
DTL-120	13	23	15	53	72	30	30	5.5	148
DTL-150	13	25	16	55	74	30	34	6	152
DTL-185	13	27	18	58	81	35	37	6.5	166
DTL-240	13	30	20	60	83	35	40	7.5	170
DTL-300	16.5	34	23	65	90	37.5	45	8.5	187
DTL-400	16.5	38	26	70	90	37.5	52	9.5	194

## Copper and Aluminum Terminal Series 铜铝接线端子系列

### DTL 铜铝接线端子 (国标)

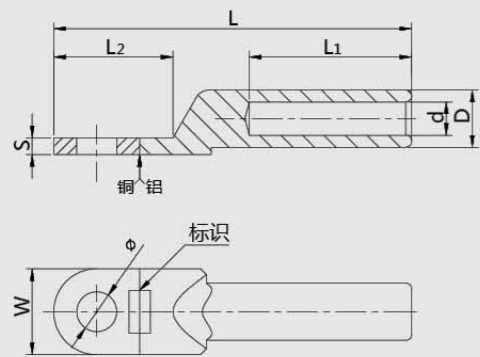

型号规格	Ø	D	d	L <sub>1</sub>	L <sub>2</sub>	W	S	L
DTL-16	8.4	10	5.5	32	22	16	3	70
DTL-25	8.4	12	7	34	25	18	3.5	75
DTL-35	10.5	14	8.5	40	29	20	3.5	85
DTL-50	10.5	16	9.5	42	31	23	4	90
DTL-70	12.5	18	12	47	34	26	4.5	102
DTL-95	12.5	21	13	50	36	28	5	112
DTL-120	14.5	23	15	53	40	30	5.5	120
DTL-150	14.5	25	16	55	42	34	6	126
DTL-185	16.5	27	18	58	47	37	6.5	133
DTL-240	16.5	30	20	60	50	40	7.5	140
DTL-300	21	34	23	65	62	45	8.5	165
DTL-400	21	38	26	70	62	52	9.5	170
DTL-500	21	42	29	75	67	60	10	190
DTL-630	方头	54	34	80	85	78	10.5	225

## Wiring Pipe Series 接线管系列

### GLG-A 通孔铝连接管 (A型)



型号规格	D	d	L
GLG-A-10	9	5.5	60
GLG-A-16	10	6.5	65
GLG-A-25	12	7.2	70
GLG-A-35	14	9	75
GLG-A-50	16	10	80
GLG-A-70	18	12	90
GLG-A-95	21	14	95
GLG-A-120	23	15	100
GLG-A-150	25	17	105
GLG-A-185	27	19	115
GLG-A-240	30	21	120
GLG-A-300	34	24	130
GLG-A-400	38	26	140
GLG-A-500	42	29.5	150
GLG-A-630	45	35	170

## Wiring Pipe Series 接线管系列

### GLG-B 通孔铝连接管 (B型)

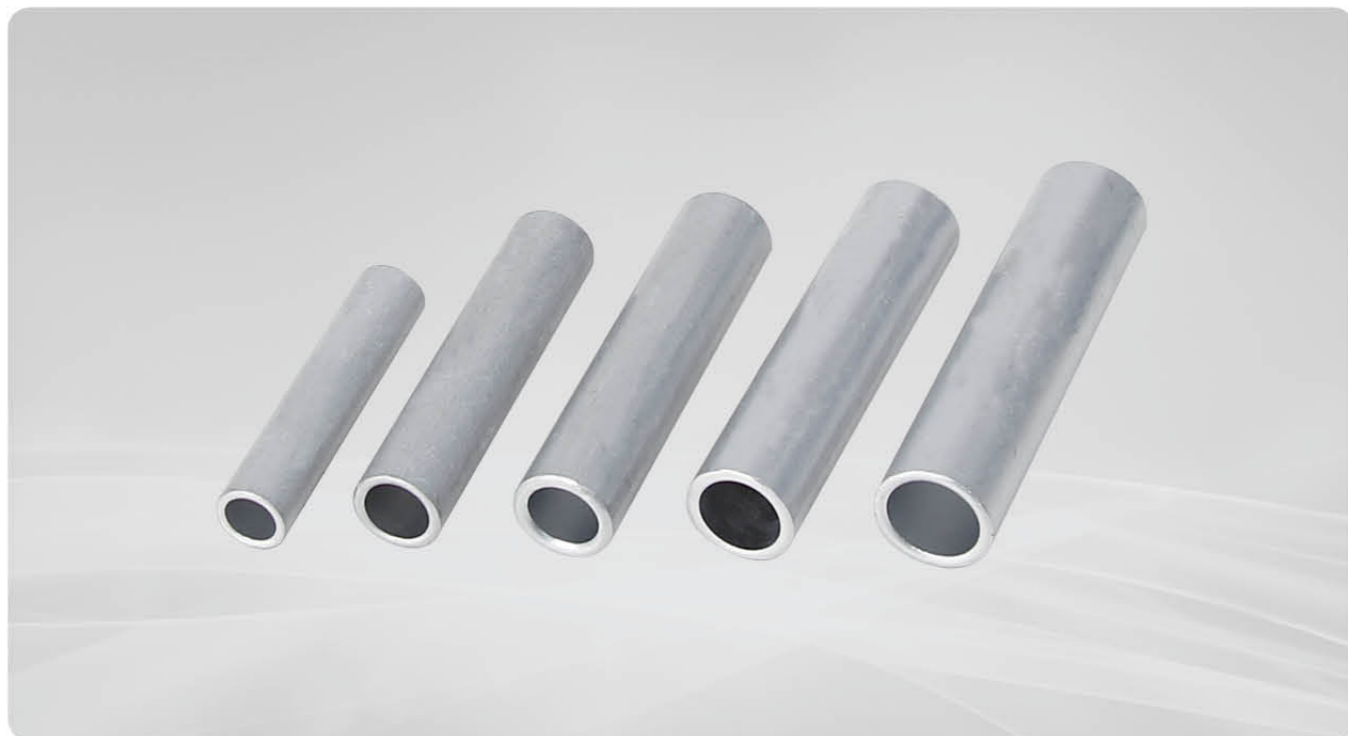

型号规格	D	d	L
GLG-B-10	8	5	53
GLG-B-16	9	6	60
GLG-B-25	11	7.5	62
GLG-B-35	12	8.5	66
GLG-B-50	15	11	72
GLG-B-70	17	12.4	82
GLG-B-95	19	14	86
GLG-B-120	21	15.6	92
GLG-B-150	23	17.6	96
GLG-B-185	25	19.4	103
GLG-B-240	27	21	113
GLG-B-300	32	24	125
GLG-B-400	37	26.7	150
GLG-B-500	40	30	150
GLG-B-630	45	35	170

## Wiring Pipe Series 接线管系列

### GLM 堵油式铝连接管 (国标)

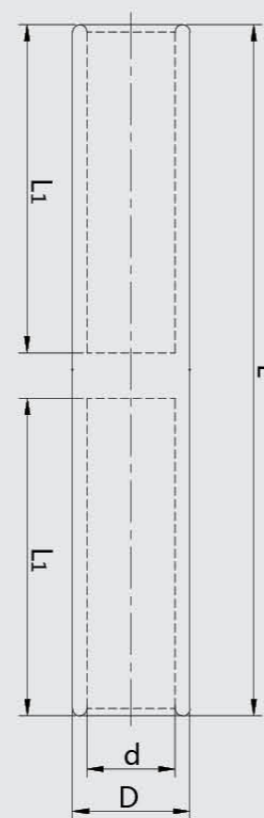

型号规格	D	d	L <sub>1</sub>	L
GLM-16	10	5.5	31	70
GLM-25	12	7	32	75
GLM-35	14	8.5	37	85
GLM-50	16	9.5	42	95
GLM-70	18	12	46	105
GLM-95	21	13	50	110
GLM-120	23	15	52	115
GLM-150	25	16	55	120
GLM-185	27	18	57	125
GLM-240	30	20	61	130
GLM-300	34	23	65	140
GLM-400	38	26	70	150
GLM-500	42	29	75	160
GLM-630	54	34	80	170

## Wiring Pipe Series 接线管系列

### GTG-A 通孔铜接管 (A型)



型号规格	D	d	L
GTG-A-10	8	5.4	50
GTG-A-16	9	6.2	56
GTG-A-25	10	7.2	60
GTG-A-35	12	8.5	64
GTG-A-50	14	10	72
GTG-A-70	16	12	78
GTG-A-95	18	13	85
GTG-A-120	20	15	90
GTG-A-150	22	16	94
GTG-A-185	25	18	100
GTG-A-240	27	20	110
GTG-A-300	31	24	120
GTG-A-400	34	26	135
GTG-A-500	38	30	150
GTG-A-630	45	36	170

## Wiring Pipe Series 接线管系列

### GTG-B 通孔铜接管 (B型)



型号规格	D	d	L
GTG-B-10	8	6	50
GTG-B-16	9	6.6	56
GTG-B-25	10	7.6	60
GTG-B-35	11	8.6	64
GTG-B-50	13	10.4	72
GTG-B-70	15	12	78
GTG-B-95	17	14	85
GTG-B-120	19	15	90
GTG-B-150	21	17	94
GTG-B-185	24	19.2	100
GTG-B-240	26	21.2	110
GTG-B-300	28	23	120
GTG-B-400	32	26.5	130



## Wiring Pipe Series 接线管系列

### ◎ GTL 铜铝连接管

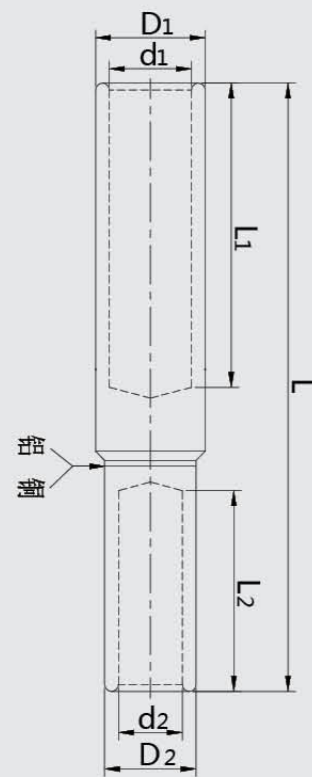

型号规格	D <sub>1</sub>	d <sub>1</sub>	L <sub>1</sub>	D <sub>2</sub>	d <sub>2</sub>	L <sub>2</sub>	L
GTL-10	10	5.3	30	8	4.2	25	70
GTL-16	11	6.3	32	9	5.3	27	75
GTL-25	12	7.3	36	10	6.3	28	80
GTL-35	14	8.5	42	11	7.3	28	85
GTL-50	16	9.5	47	13	8.5	30	90
GTL-70	18	11.5	50	15	9.5	33	100
GTL-95	21	13.5	52	17	11.3	38	110
GTL-120	23	15.1	55	19	13.3	40	110
GTL-150	25	16.5	56	21	14.9	44	115
GTL-185	27	18.5	58	23	16.3	45	125
GTL-240	30	20.7	62	26	18.3	48	130
GTL-300	34	23.5	65	29	20.5	51	145

## Wiring Pipe Series 接线管系列

### ◎ GTM 堵油式铜连接管 (国标)

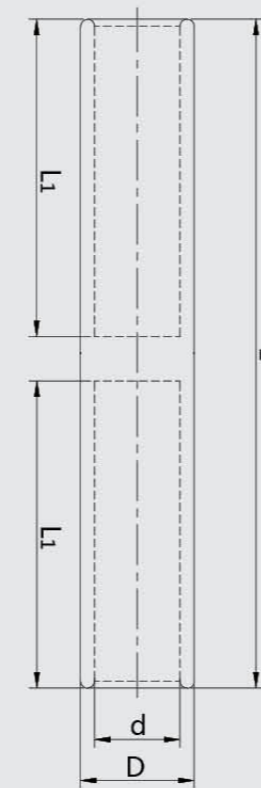

型号规格	D	d	L <sub>1</sub>	L
GTM-10	9	5	28	62
GTM-16	10	6	30	65
GTM-25	11	7	32	70
GTM-35	12	8.5	34	75
GTM-50	14	9.6	35	80
GTM-70	16	12	41	90
GTM-95	18	13	43	95
GTM-120	20	15	46	100
GTM-150	22	16	48	105
GTM-185	25	18	50	110
GTM-240	27	20	55	120
GTM-300	30	23	60	130
GTM-400	34	26	64	140
GTM-500	38	29	70	155
GTM-630	45	34	80	170

## 产品质量保证承诺

为了响应国家“开展质量保证承诺活动”的倡议，进一步提高产品质量，从而提高我公司产品在国际、国内市场的地位和为用户中的信用度，真正实现“标准制定者、用户守护者、价值创造者”的宗旨，我们向社会各界、广大用户、承诺如下：

1、进一步完善企业质量保证体系，加强质量管理工作，保证出厂产品达到国家标准或合同规定的技术条件，并使出厂产品合格率达 100%。

2、保证按合同要求交货，对需要技术服务的，派专业技术服务人员进行技术指导，安装，调试工作，使产品正常运行。

3、保证为用户提供优良的售前、售后服务，为用户在订购公司产品后，使产品性能和使用要求满足用户的需要，并提供相关的资料。若产品在“三包”期内出现质量问题，本公司接到用户通知后，将在 24 小时内作出答复。

4、实行产品质量三包“包修、包换、包退”。“三包”期限为一年，产品在“三包”期内确属产品质量问题，我们将严格履行合同中规定义务。凡超过“三包”期限的产品，若用户需要维修服务，保证提供维修服务。

5、若用户需进行技术培训，本公司帮助培训有关人员，并对如何操作、保养，维修进行指导，对重点用户进行走访质量跟踪。

6、定期召开用户座谈会，并对用户来函、来电、来访等信息，及时作好登记传递、分析、处理、反馈等工作，并根据用户需求改进产品性能，不断提高产品质量。

浙江强力电力金具有限公司  
ZHEJIANG QLG ELECTRIC POWER FITTING CO.,LTD.

